



27 Abbotsfield Close, Hastings, TN34 2DT

£295,000





£295,000

27 Abbotsfield Close

Hastings, TN34 2DT

- SEMI-DETACHED HOUSE
- 24FT LIVING ROOM/DINING ROOM
- SOUTH/EAST GARDEN
- CUL DE SAC LOCATION
- GAS HEATING
- THREE BEDROOMS
- DRIVEWAY AND GARAGE
- NO CHAIN
- WALKING DISTANCE ST HELENS PARK
- DOUBLE GLAZING

Abbott and Abbott are offering for sale , chain free , this 1970s built semi detached house located in a quiet cul de sac within walking distance of St Helens park.

The property has double glazing and central heating but requires kitchen and bathroom fittings to be updated.

Externally there is a pretty south-east facing garden, driveway and garage.



Entrance hall

Living room/dining room

24'10" x 10'9" - 9'6" (7.58 x 3.29 - 2.90)

Kitchen

11'5" x 7'0" (3.49 x 2.15)

Landing

Bedroom 1

12'9" x 9'10" (3.90 x 3.0)

Bedroom 2

11'5" x 9'3" (3.49 x 2.83)

Bedroom 3

9'6" x 6'6" (2.9 x 2.0)

Bathroom

Separate wc

Front garden

Rear garden

Driveway

Garage







Floor Plans

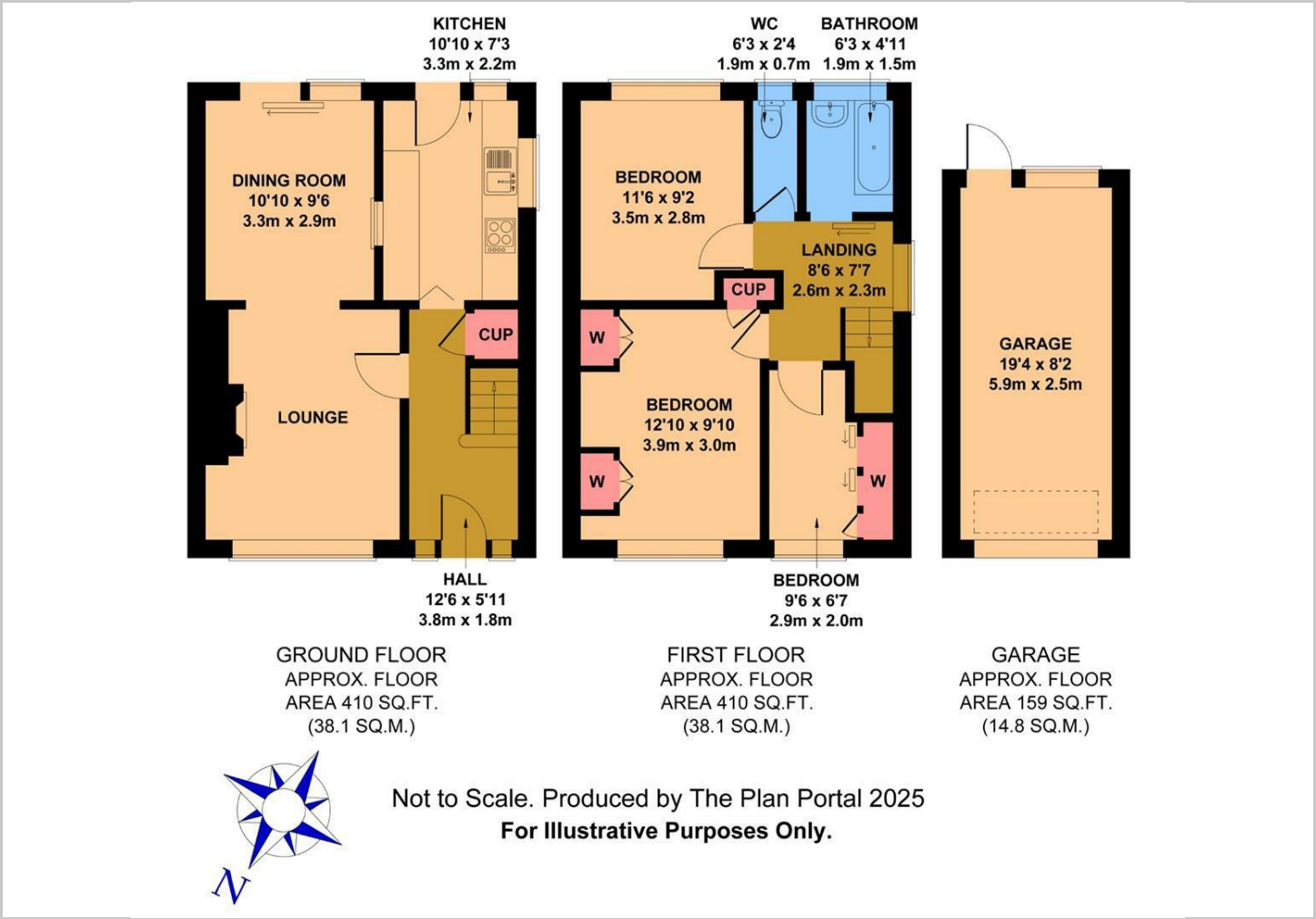

Viewing

Please contact our Sales Office on 01424 212233 if you wish to arrange a viewing appointment for this property or require further information.

The particulars are set out as a general outline only for the guidance of intended purchasers or lessees, and do not constitute, any part of a contract. Nothing in these particulars shall be deemed to be a statement that the property is in good structural condition or otherwise nor that any of the services, appliances, equipment or facilities are in good working order. Purchasers should satisfy themselves of this prior to purchasing.

Location Map

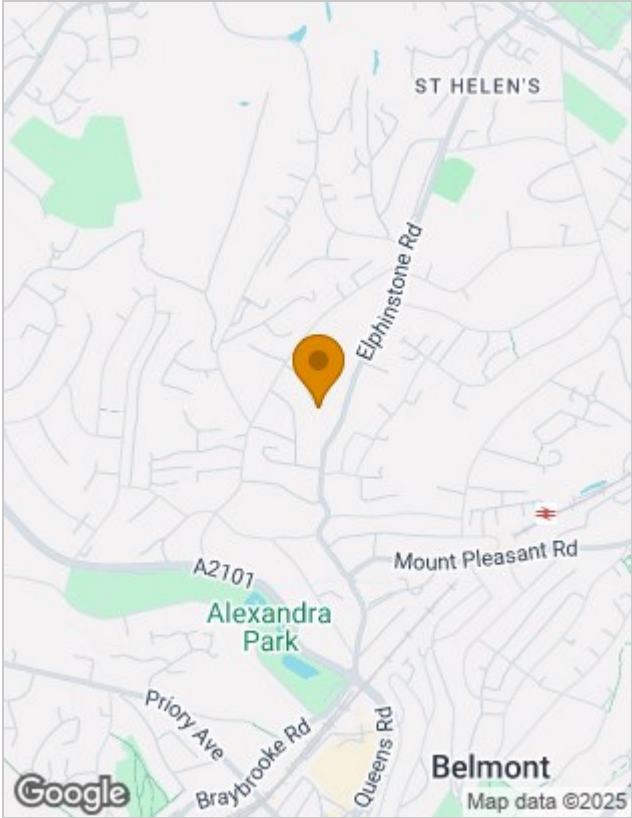

Energy Performance Graph

